

COPYRIGHT ALL RIGHTS RESERVED

DO NOT SCALE

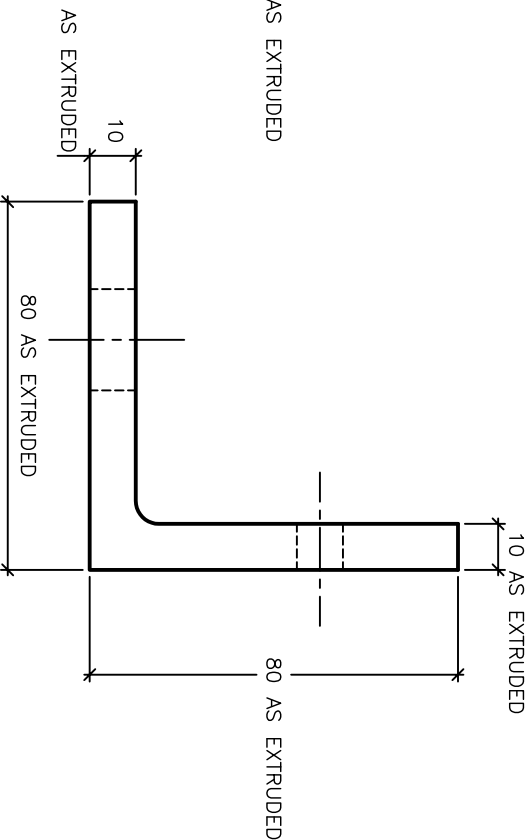
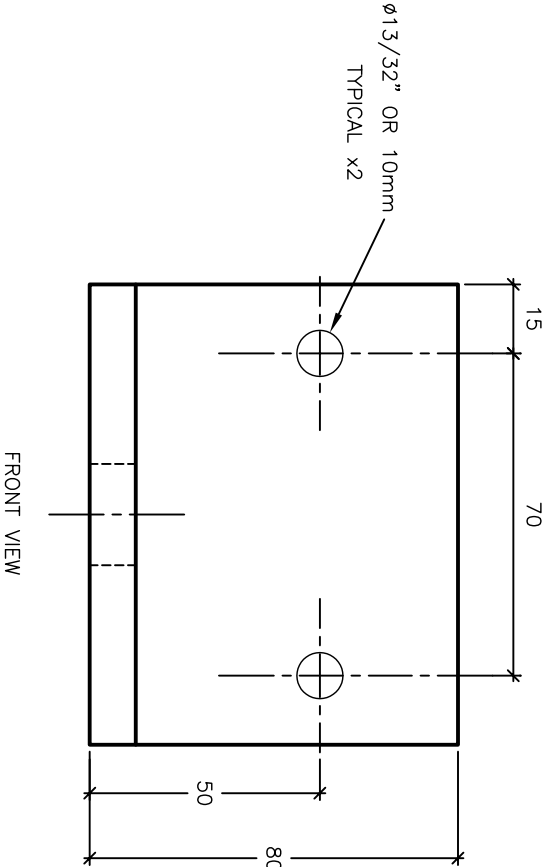
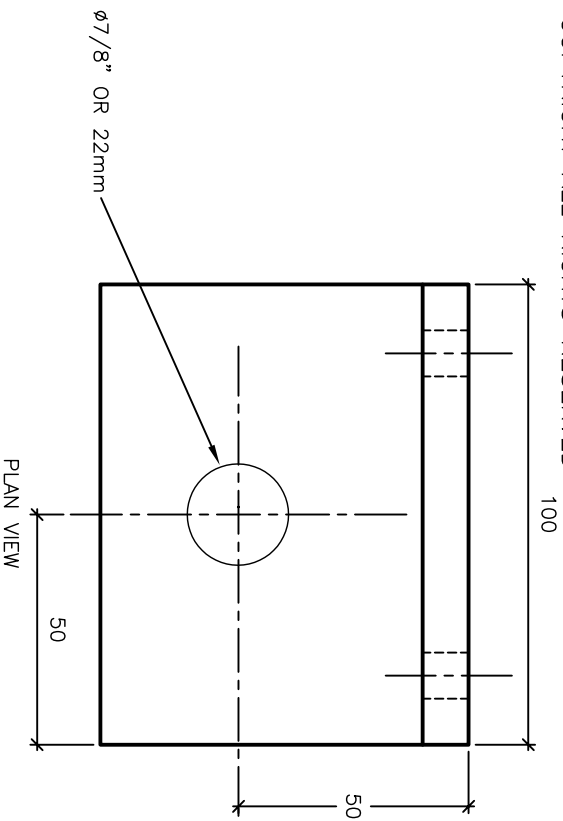

NOTE—THE MATERIAL USED IS TO BE OF
 GRADE 6063 T5 OR 6061 T5
 ALUMINIUM EXTRUSION.
 —THE EXTRUSION IS 80x80x10
 STRUCTURAL ANGLE.
 *COMALCO SECTION No. E.20709
 —ALL SHARP EDGES ARE TO BE
 REMOVED.
 —APPROX. WEIGHT OF BRACKET 0.385kg
 —MATERIAL MASS 4.071 kg/m

DRAWING HAS BEEN REDRAWN FROM A3-289 (4/4/86)

**MARINE DOCK SYSTEMS
 PTY LTD**

**PONTOON
 FLOAT BRACKET**

BKT—FLOAT—289

TOLERANCES
 LINEAR ±1.0
 ANGULAR ±0.2°
 HOLE CTRS ±0.5

SCALE N.T.S.
 DRAWN BJM
 DATE 7.11.95

DRAWING No. **A4-289**
 REV B